

Queen  
Street  
Studio



30 days  
&  
30 nights

FRASERSTUDIOS

A month-long celebration of FraserStudios before we pull down the roller doors for the very last time

**FraserStudios**

**10-14 Kensington Street, Chippendale**

**1-30 June 2012**

"Our House" concept: **Julia Lenton** and **Kym Lenoble**

Project Coordinator: **Kali Reid**

Blueprint floor: **Rhys Morris**

# "Our House"

An exhibition from our final  
Bonus Round of Visual Arts Residents

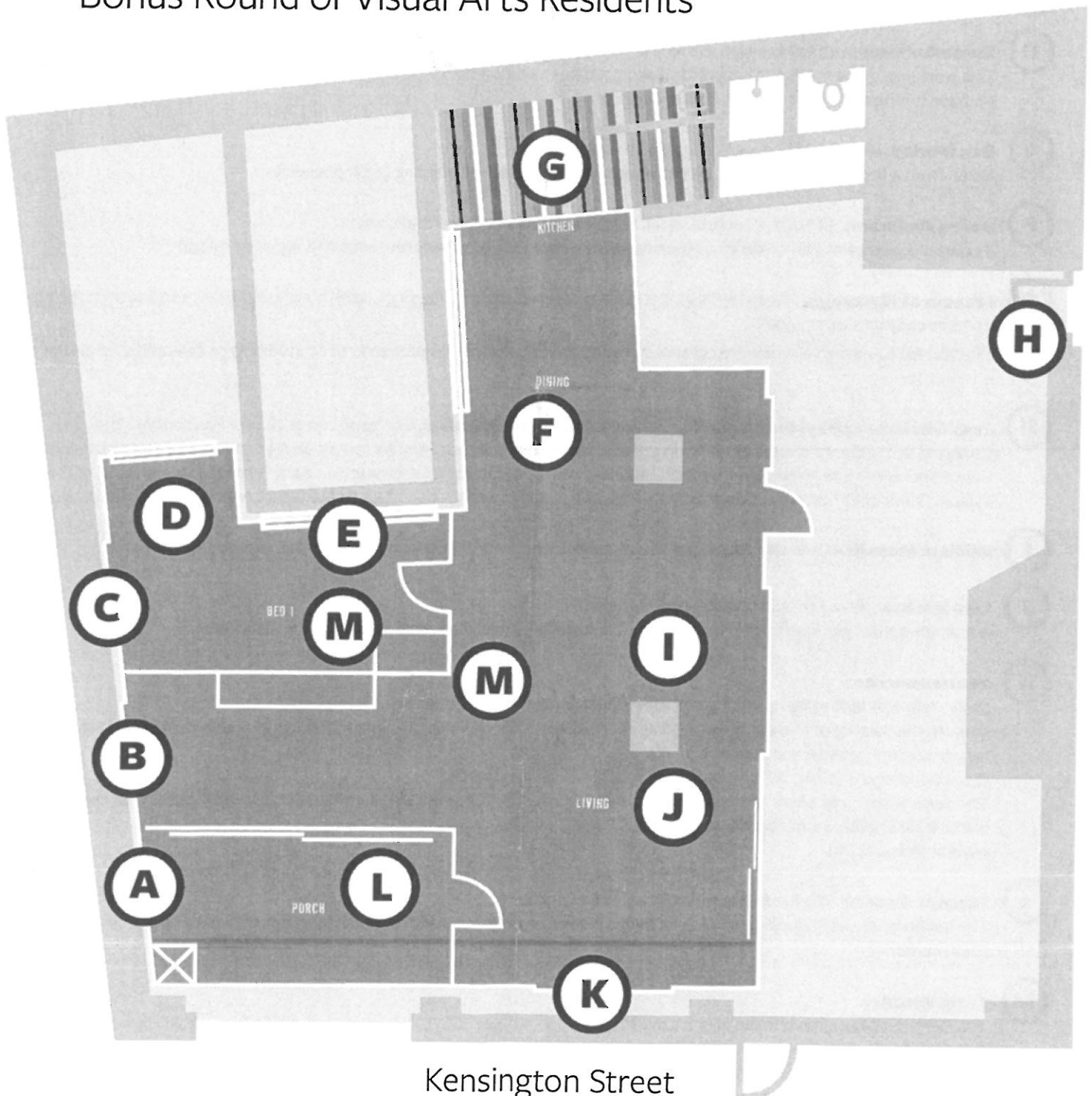

FRASERS PROPERTY

- A Tega Brain**, *Species Unknown (1-3)*, pigment prints on cotton rag, 2011
- B Li Cui**  
*Jessica*, 30 x 40cm, mixed media and oil on board, 2011  
*Black hair*, 30 x 40cm, mixed media and oil on board, 2011  
*Somewhere to go*, 30 x 40cm, mixed media and oil on board, 2011  
*Deep breath*, 30 x 40cm, mixed media and oil on board, 2012  
*Train to be found*, 30 x 40cm, mixed media and oil on board, 2012  
*White summer*, 30 x 40cm, mixed media and oil on board, 2012  
*Silver smile*, 80 x 100cm, oil on board, 2012  
 People unconsciously set themselves in an invisible bubble that is influenced by their current material and cultural circumstances, but determined by their cultural background and past life experience. I aim to show the physical and mental traces of the evolution of people's identity, to evoke their primitive and genuine selves hidden beneath the surface.
- C Bronia Iwanczak**, *Emergency Stain Glass Window*, hi-end disco light gels, 2012
- D Sarah Goffman**, *Lab work*, mixed media and paintings, 2012  
 This work was made for Appin Labyrinth, a site-specific exhibition held in a Motel in Appin organised by Bronia Iwanczak and Lisa Andrew. It is being re-presented at FraserStudios.
- E Ben Morley**, *View from L'Aquila (1 & 3)*, oil on canvas, 2012  
 Taken from a series of works based on the view from my apartment building in Chippendale.
- F Aaron Anderson**, *STRUCT*, concrete, steel, marbles, bricks and wood table, 2012  
 As construction gives way to destruction, one mode of operation is rendered inept and replaced by another.
- G Francesca Mataraga**, *QueenSt(Frasers) Kitchen Project (including Passing)*, acrylic paint, light box, existing architecture and items already on site, 2012/2004  
 The *QueenSt(Frasers) Kitchen Project* was designed specifically for the kitchen area of Studio 10 to celebrate the end of projects on this site.
- H Jess Olivieri and Hayley Forward** with the **Parachutes for Ladies**, *Changing of the Guard: Formation*, video, 2011  
*Changing of the Guard* is a series of works created for and exhibited in Primavera 2011, in response to the site of the Museum of Contemporary Art. With the gallery (then) in a state of flux, undergoing renovations, *Changing of the Guard* looks at the role the Visitors Services Officers play in demarcating the gallery space as they become the human architecture of the institution.
- I William Mansfield and Eddie Sharp**, *Mount Paramount Mountain*, mixed media video installation, 2010/2012
- J Lisa Andrew**, *Heads of State*, ink on interfacing, 2012  
 A memento mori incorporating the heads of Sam, James, Pete, Rhys, Kym and Julia as hunting trophies.
- K Yvette Hamilton**  
*Sadly Missed: A Mourning Portrait*, single channel DVD duration 1:54mins, 2012  
 I mourn the passing of this space as I would mourn a person. This work is a memorial portrait to this building and those who have brought a creative vibrancy to it.  
*In Loving Memory (1-16)*, hand-printed photo-transfer on canvas, 2012  
 This series is a survey of sorts, a mapping and memorialisation of this building's current essence, created with a keen awareness of the transient nature of my time within it.  
[www.aether-art.com](http://www.aether-art.com)
- L Tammie Castles**, *The Great Buckingham Street Project*, 2012  
 The residents of Great Buckingham Street in Redfern were given postcards and asked to write a memory of the street; these are their memories.
- M Craig Waddell**  
*The Painter*, polyurethane foam, acrylic, oil paint, 2012  
*Two faced*, polyurethane foam, acrylic, oil paint and plastic crate, 2012  
*The Painter* and *Two faced* are part of an ongoing body of sculptures and ink drawings depicting flights of fantasy that blur the lines between traditional and non-traditional art methods. These possible self-portraits have their origins in a series of ink drawings made after Goya's *Los caprichos* print series.